

PLAN SHOWING THE PROPOSED CONSTRUCTION OF A BUILDING FOR 'VARANANDHINI MANSION' (DELUX ACCOMODATION FOR SENIOR CITIZENS WITH ALL AMENITIES) AT PLOT No. A1, SHANTHEE NIKETHAN COLONY 3<sup>rd</sup> STREET, PART OF SURVEY No. 677/1&2, 678/1&2, MADAMBARKAM VILLAGE, SAIDAPET TALUK, ANNA DISTRICT

APPROVED LAYOUT U.O. No. 15/15/2003/334/73  
 SCALE: 1 INCH = 8 FEET (OR) 1 CM = 100 CM

**JOINERY:**

C.G. COL. GATE	7'0" x 7'0" (OR) 2.13 x 2.13 M
D. PANEL DOOR	3'3" x 7'0" ... 1.00 x 2.13 M
P1. " " "	3'0" x 7'0" ... 0.91 x 2.13 M
D2. " " "	2'6" x 7'0" ... 0.76 x 2.13 M
W. " WINDOW	4'0" x 4'6" ... 1.22 x 1.37 M
W1. " " "	3'0" x 4'6" ... 0.91 x 1.37 M
V. " VENTILATOR	4'0" x 2'6" ... 1.22 x 0.60 M
J. RCC. JALLY	7'0" x 4'6" ... 2.13 x 1.37 M

**AREA:**

	SQ. FT (OR)	SQ. M
TOTAL PLOT AREA	6637.00	616.58
G FLOOR	2528.12	234.86
F FLOOR	2528.12	234.86
HEADROOMS	527.00	48.95

**STAIRCASE:**

WIDTH OF THE STAIR	3'6" (OR) 1.06 M
TREAD	10'0" ... 0.25 M
RISER	0'9" ... 0.17 M

**COLOUR INDEX:**

OWNER'S BOUNDARY	---
PROPOSED BUILDING	---
EXISTING ROADS	---

**SECTION OF WELL 4'0" DIA**

**SECTION OF SEPTIC TANK**

Mrs. Varanandhini Raghavan  
 MRS. VARANANDHINI RAGHAVAN  
 POWER OF ATTORNEY HOLDER  
 FROM MR. R. MADHAVAN  
 PROPERTY OWNER

**Surveyor**  
 M. Mohan Rao, D.C.E.  
 LICENSED SURVEYOR  
 Registration of Madras  
 Reg. No. 14  
 MBABTUR TOWN SHIP  
 ALANDUR MUNICIPALITY  
 Consulting Engineer  
 Office: 15, Alandur Road,  
 NAGAR, MADRAS - 600 017

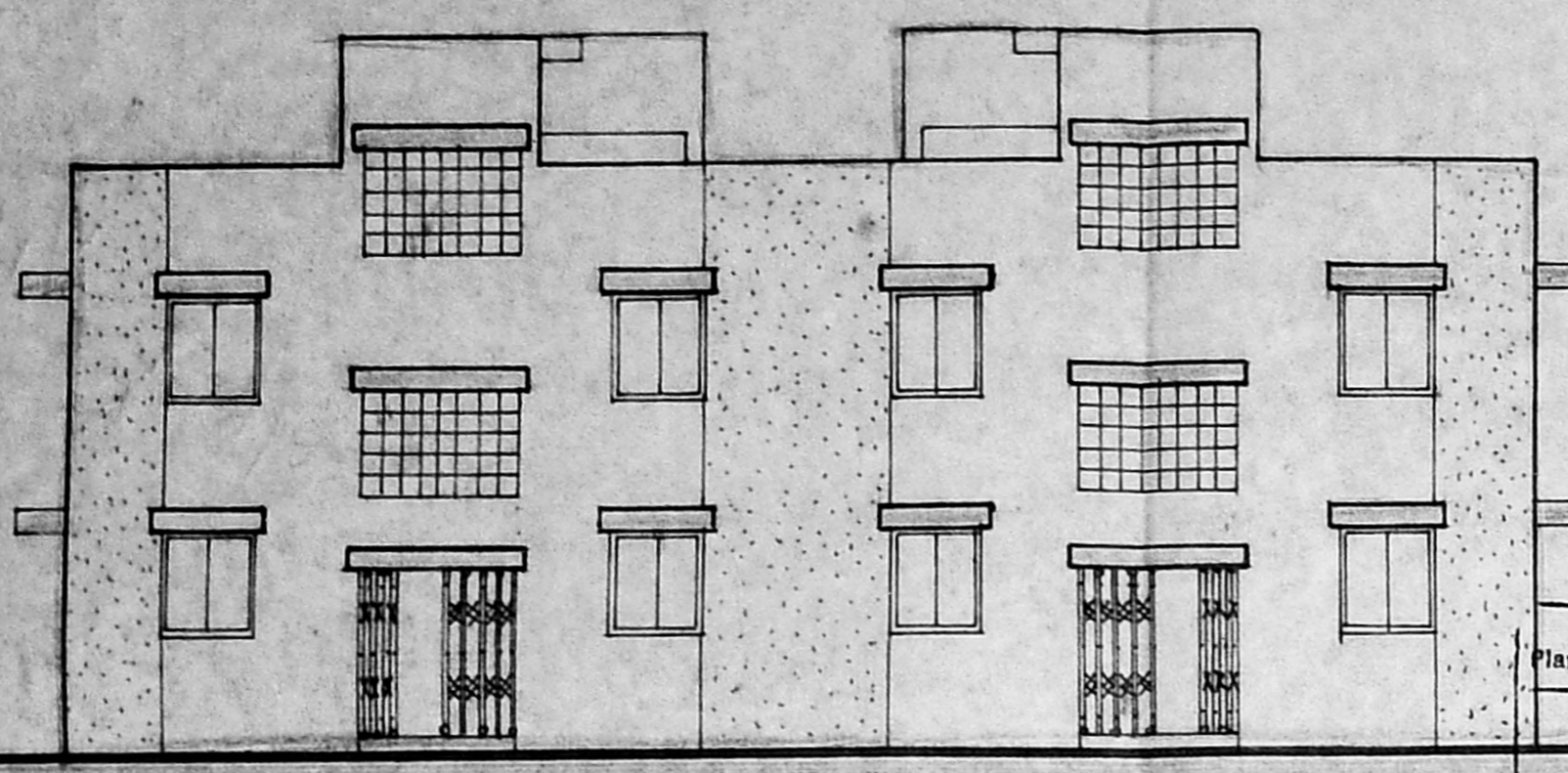

FRONT ELEVATION

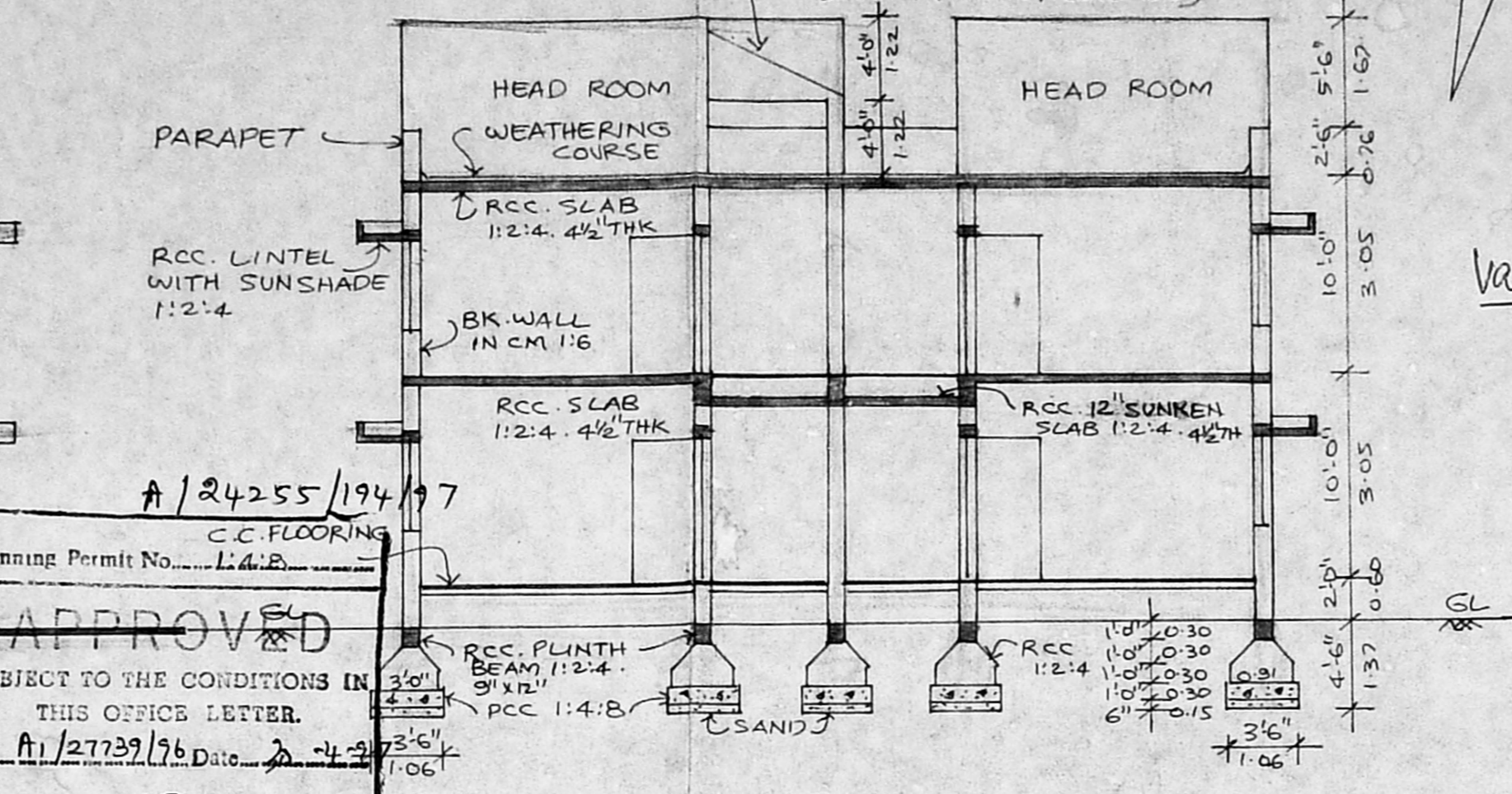

SECTION ON-AB

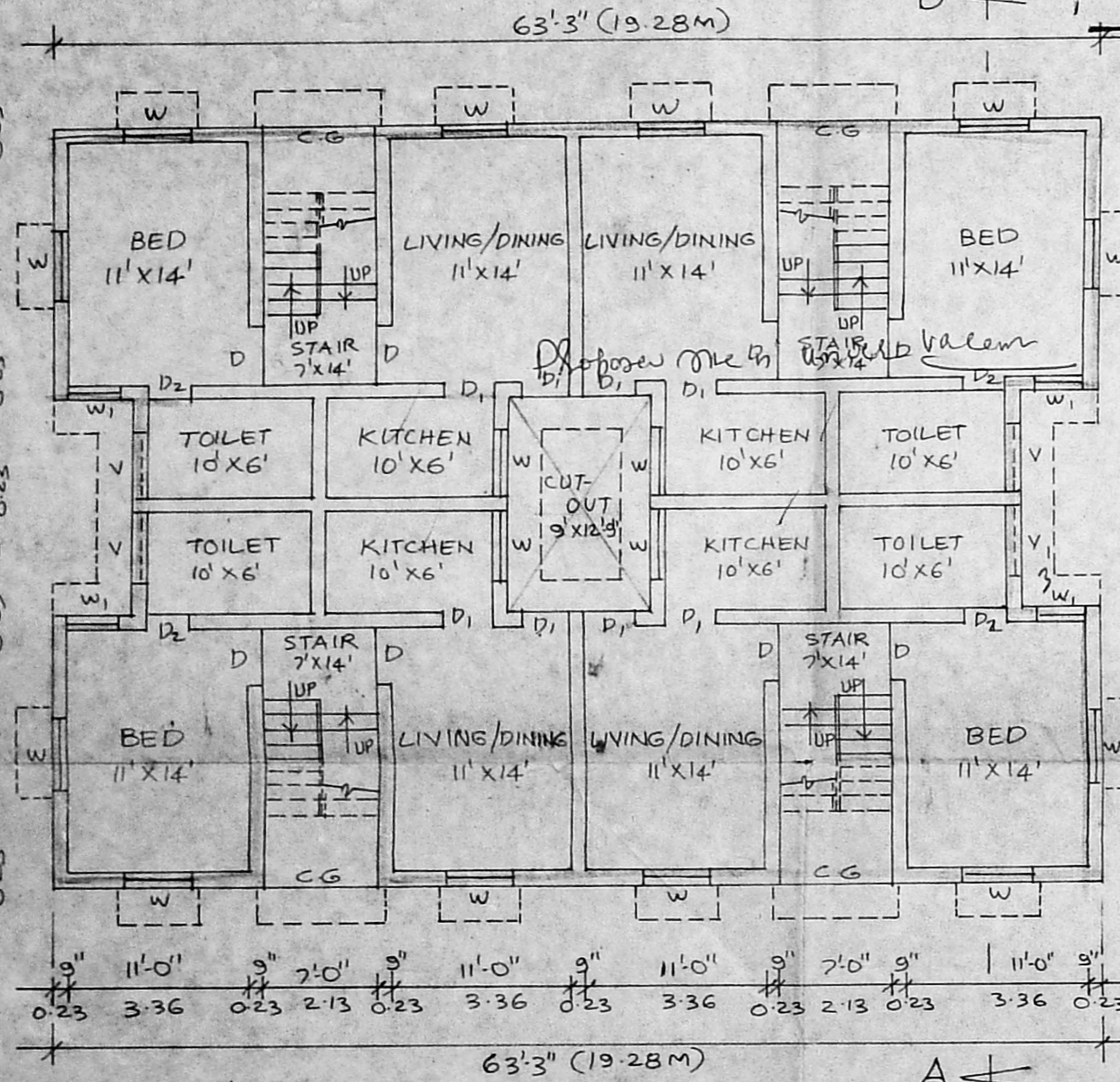

GROUND FLOOR PLAN

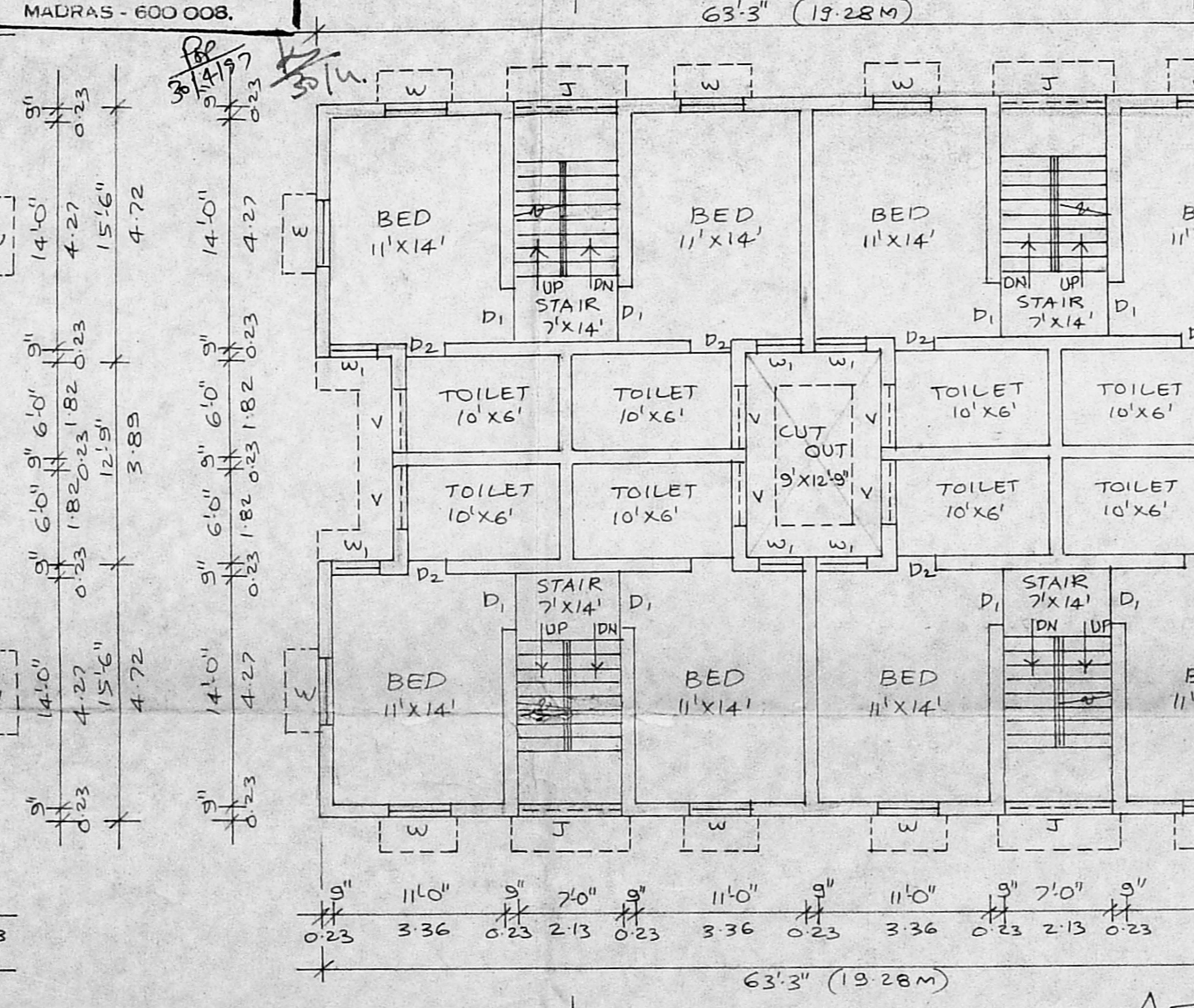

FIRST FLOOR PLAN

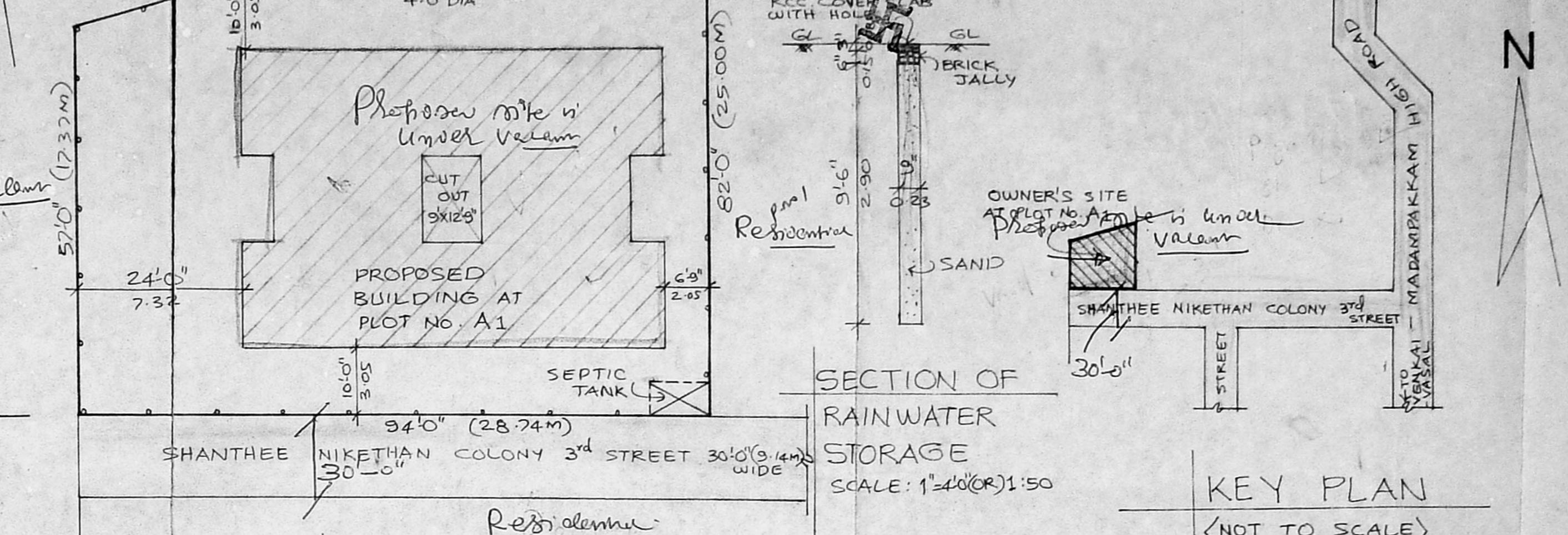

SITE PLAN

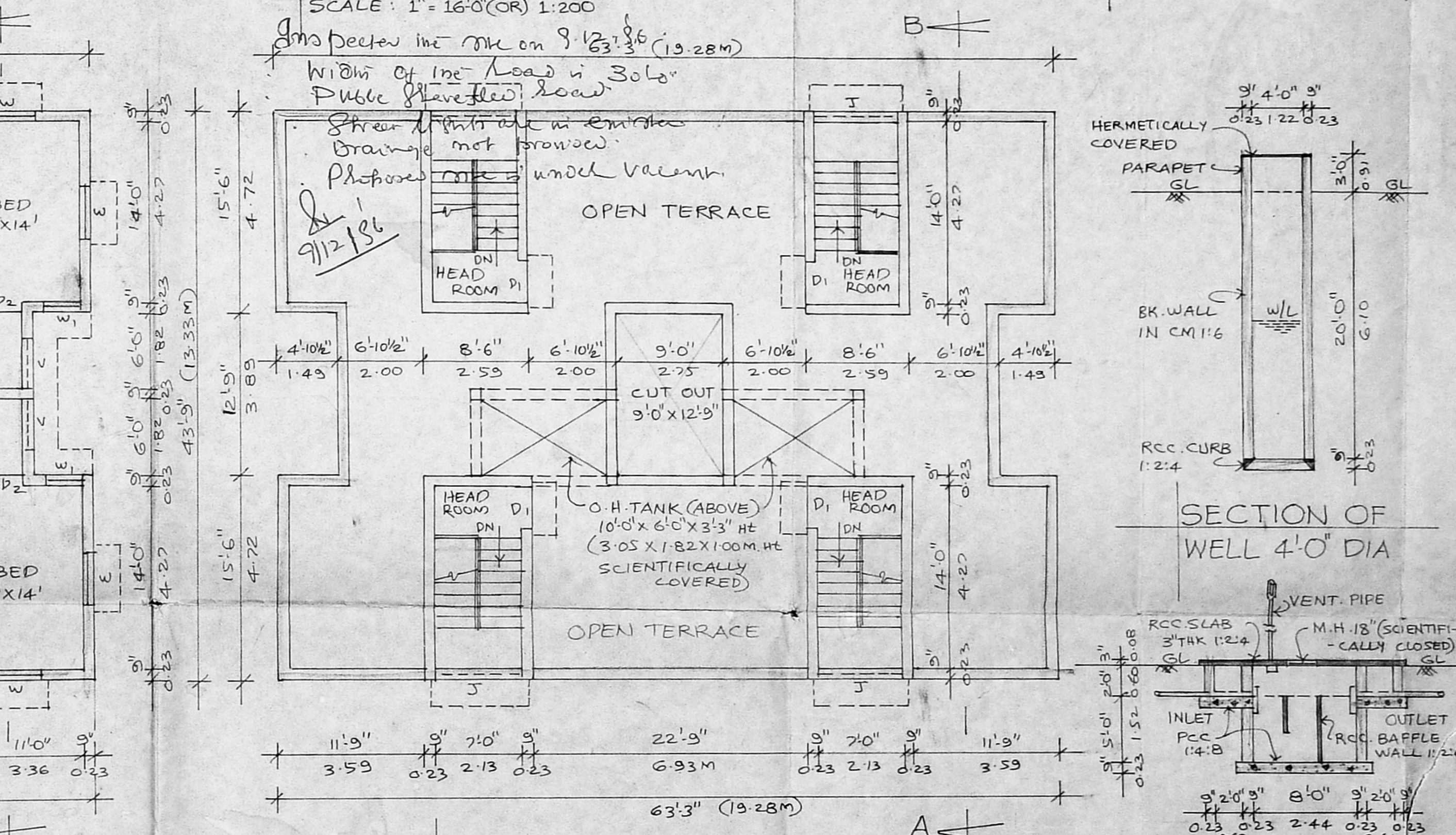

TERRACE FLOOR PLAN

A/24255/194/97  
 Planning Permit No. 1242  
 APPROVED  
 SUBJECT TO THE CONDITIONS IN THIS OFFICE LETTER.  
 No. A1/27739/96 Date: 2-4-2003  
 FOR MEMBER SECRETARY  
 MADRAS METROPOLITAN  
 DEVELOPMENT AUTHORITY  
 MADRAS - 600 008.